

# Solar Cap with Accessory Connect

## Installation Notes

- Do not cut any wires. Any extra wire length can be coiled up.
- Replace battery when required with 14500 or 14505, 3.2V, 600 mAh, LiFePO4 (Lithium Phosphate) battery.

### Components (Each sold separately)

Post Cap (Style May Vary)

Dome Side Light

Stair/Side Light (Full Cover, Half Cover)

Under Rail

2' Harness Extension

2 Output Splitter

## Step 1

### Mount lighting fixture to post or rail

- Use a template below to drill required holes for light accessory.
- For Dome Light run connector through 3/8" hole and install back plate with two screws included. Place the dome/lens portion of the light over the back plate at a slight angle and rotate clockwise to lock in place.
- For Stair/Side Light run connector through 3/8" hole and install lens with two screws included. Place either the full or half cover onto the lens by snapping into place.
- For Under Rail light run connector through 3/8" hole and mount using the two screws included.

## Step 2

### Connect to Solar Cap

- Run harness from light accessory to cap.
- Remove pull tab in battery compartment.
- Plug the male connector attached to the light to the female connector on bottom of cap. Press firmly until the connection is fully engaged.
- If additional wire length is required the 2' harness extension can be used between cap and light. Using the 2 output splitter allows two lights to be powered by one post cap. (Maximum of 2 lights per solar cap is recommended).

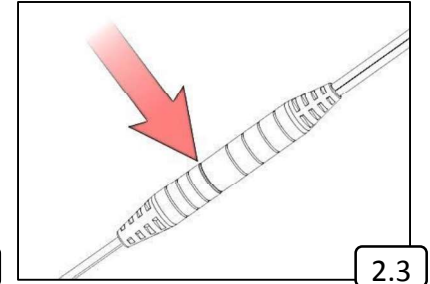
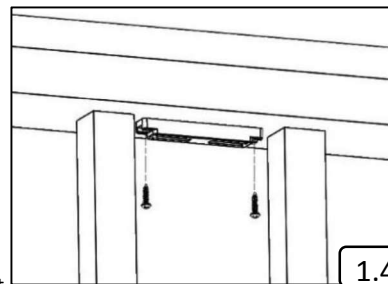
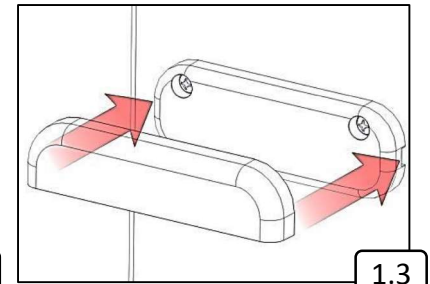
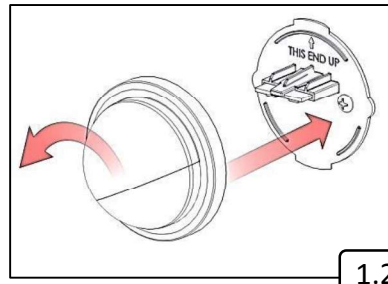

## Step 3

### Finalize Installation

- Apply a bead of clear exterior silicone caulking (not supplied) where the Post Cap Light will be installed onto the post or post wrap. Then place Post Cap Light onto the adhesive.

